

## TILT LATCH CONFIGURATION KEY

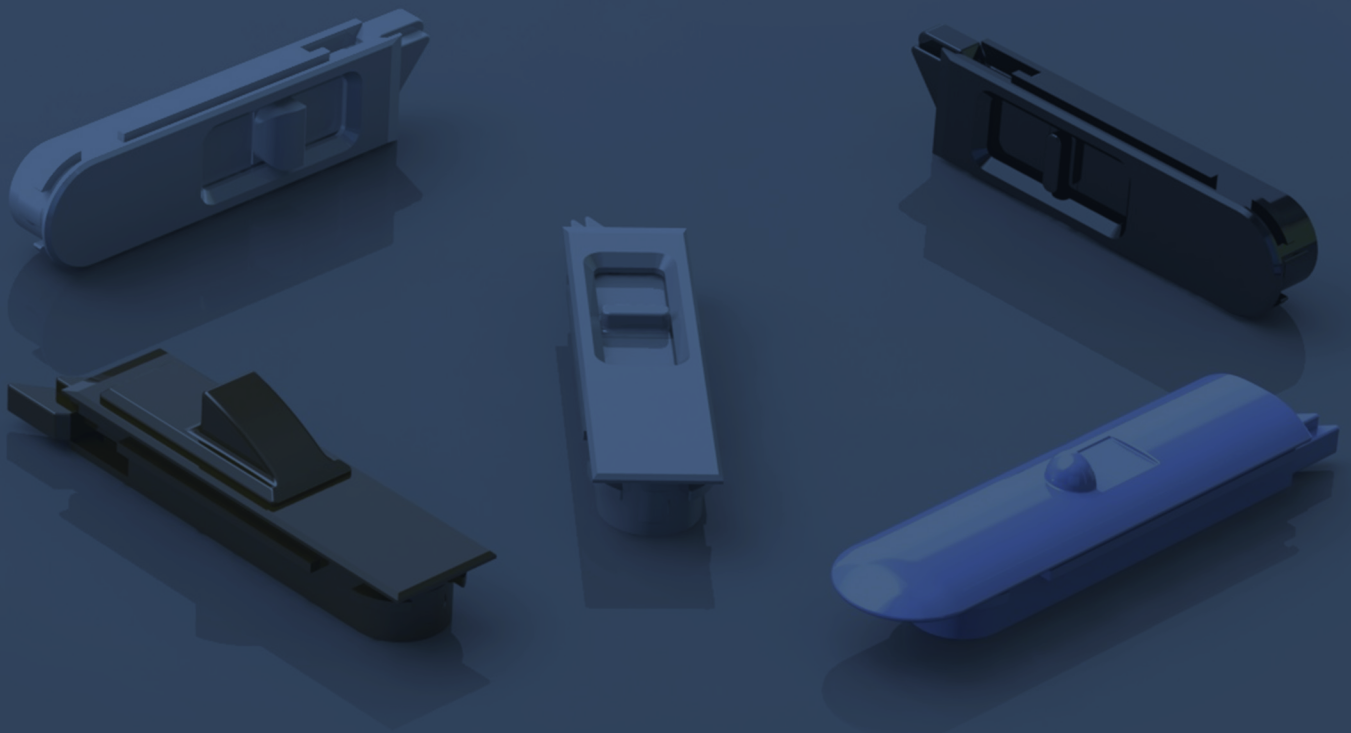

Assorted Configurations Available

To complete your customized  
Tilt Latch Part #, please choose a 4 digit  
key from each of the 3 sections below

Part # : **1** **2** **3**  
XXXX - XXXX - XXXX

## 1 Select Body Style & Setback

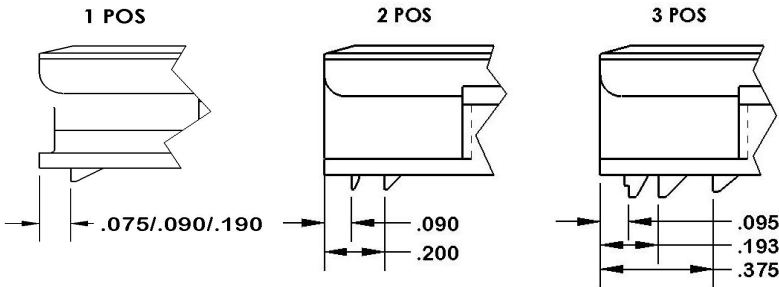

Style	Square	Radius
LH1 POS .090	2397	2488
RH1 POS .090	2398	2489
LH1 POS .190	2486	2453
RH1 POS .190	2487	2454
LH1 POS .075	2738	
LH1 POS .075	2739	
LH2 POS		2693
RH2 POS		2694
LH3 POS		2685
RH3 POS		2686

## 2 Select Nose Style & Offset

Wedge 11/32

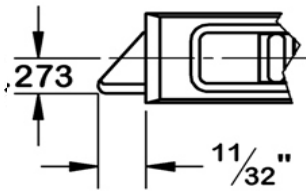

LH: 2461  
RH: 2462

Scalloped 3/8

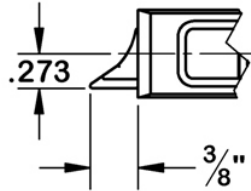

LH: 2451  
RH: 2452

Scalloped 3/8

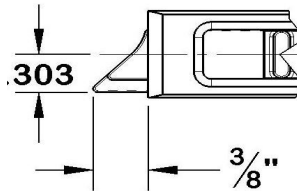

LH: 2689  
RH: 2690

Scalloped 7/16

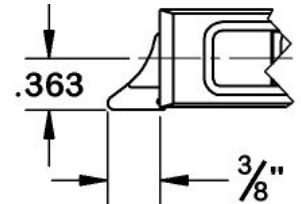

LH: 2702  
RH: 2703

Wedge 7/16

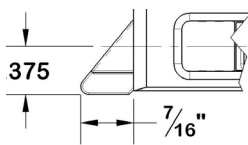

LH: 2734  
RH: 2735

Rodon Recommended Tilt Latch Slot

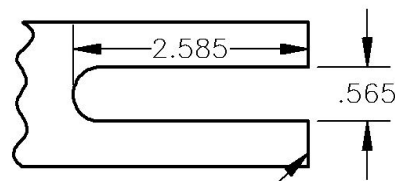

SIDE OF SASH

## 3 Select Button Style



2408 Low

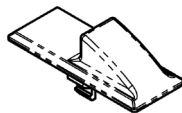

2427 Superior



2460 Medium



2580 Top

## Custodial Tilt Latch

Multi setbacks, noses and offset variations can be tooled upon request

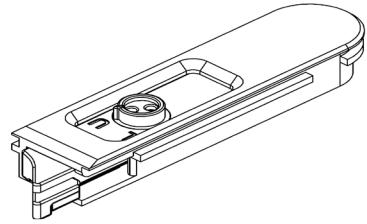

### 1 Select Body Style & Setback

Square

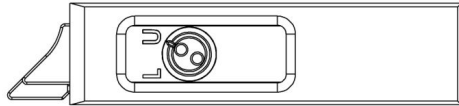

Radius

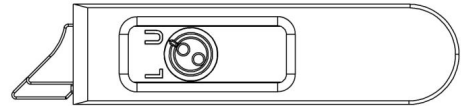

1 POS

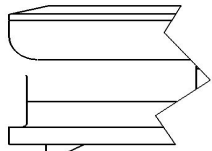

.075/.090/.190

2 POS

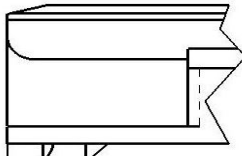

.090  
.200

3 POS

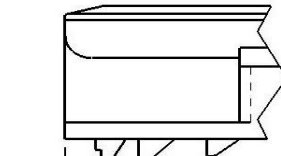

.095  
.193  
.375

Style	Square	Radius
LH1 POS .090	2800	
RH1 POS .090	2801	
LH1 POS .190		2796
RH1 POS .190		2797
LH3 POS		2724
RH3 POS		2725
LH1 POS .075	2868	
RH1 POS .075	2869	

### 2 Select Nose Style & Offset

Wedge 11/32

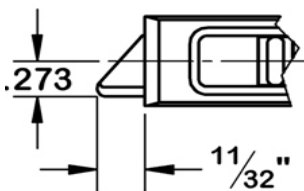

LH: 2866  
RH: 2867

Scallop 3/8

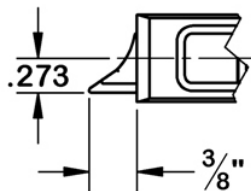

Scallop 3/8

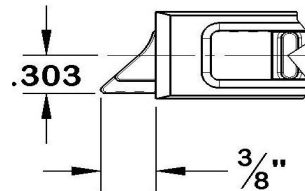

LH: 2718  
RH: 2719

Scallop 7/16

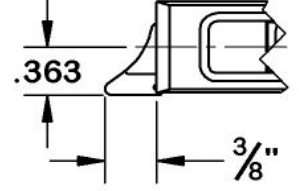

LH: 2794  
RH: 2795

Wedge 7/16

